

Mitrani Hall

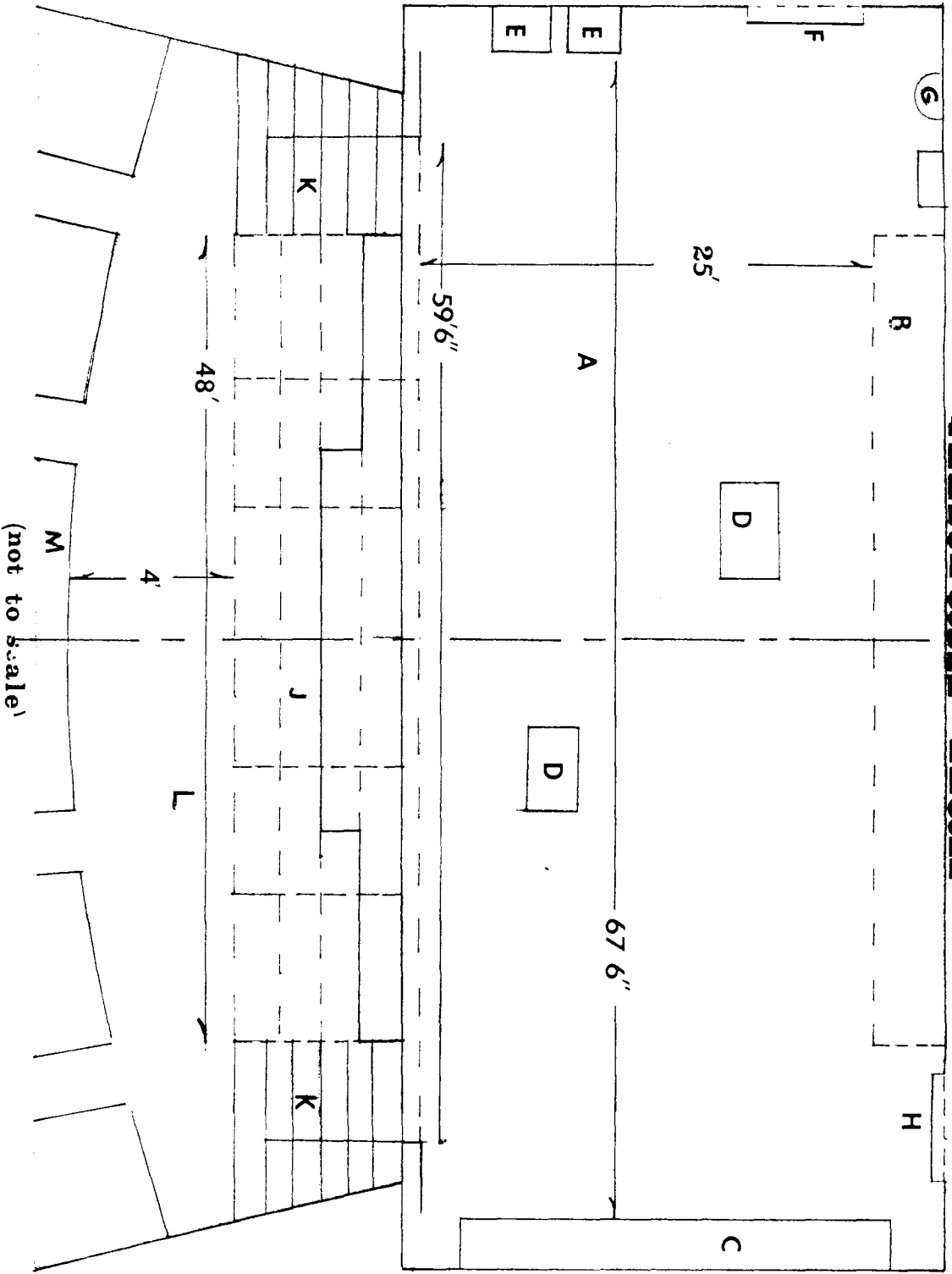

- A = STAGE PROPER
- B = ACOUSTICAL SHELL STORAGE
 - OPTION #1 - 30' S.L. - S.R.
 - X 5'-6" U.S. - D.S.
 - OPTION #2 - 6' S.L. - S.R.
 - X 10'-6" U.S. - D.S.
 - OPTION #2 ELIMINATES USE OF PIP'S #28 - 32
 - OPTION #3 - OCCUPY'S 6' OF LOADING DOCK DOOR AREA
- C = FLY RAIL
(SEE LINE SETS FOR IDENTIFICATION)
- D = TRAP
(CONTACT HOUSE T.D. FOR EXACT LOCATION AND INTENT TO USE)
- E = SOUND CABINET STORAGE
OCCUPY'S 2' X 5'-9" OF SPACE 5'-4" U.S. OF D.S.R. WALL
- F = LOADING DOORS (8' X 19')
LOADING DOCK ADJACENT IN PRODUCTION SHOP AREA -- DOORS = 7' X 21'
- G = LADDER ACCESS TO GRID
- H = BACK STAGE ACCESS FIXTURES
- I = ADJUSTABLE STAGE APRON
2' X 8' ADJUSTABLE SECTIONS ... INDICATED BY HIDDEN LINE
SOLID LINE INDICATES NORMAL PRESET
- J = STEPS TO STAGE LEVEL.
- K = ORCHESTRA PIT (AUDIENCE LEVEL)
- L = HOUSE/SIGHTLINES